

Mount the curtain on the tube

PARTS

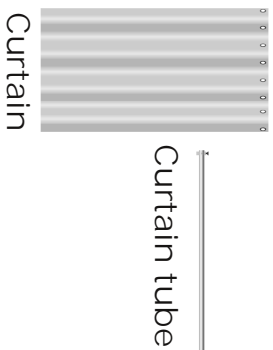

1 Prepare the tube by creating an opening for the curtain.

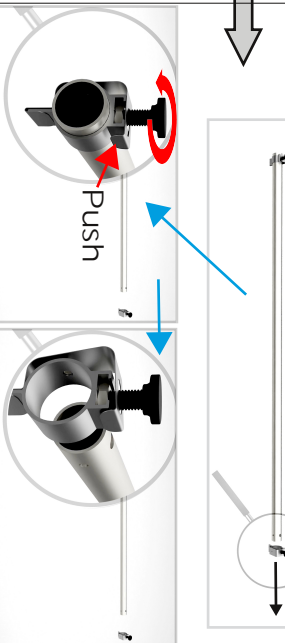

2 All curtains have a FRONT SIDE and a BACK SIDE.

These pictures show the BACK SIDE of the curtain

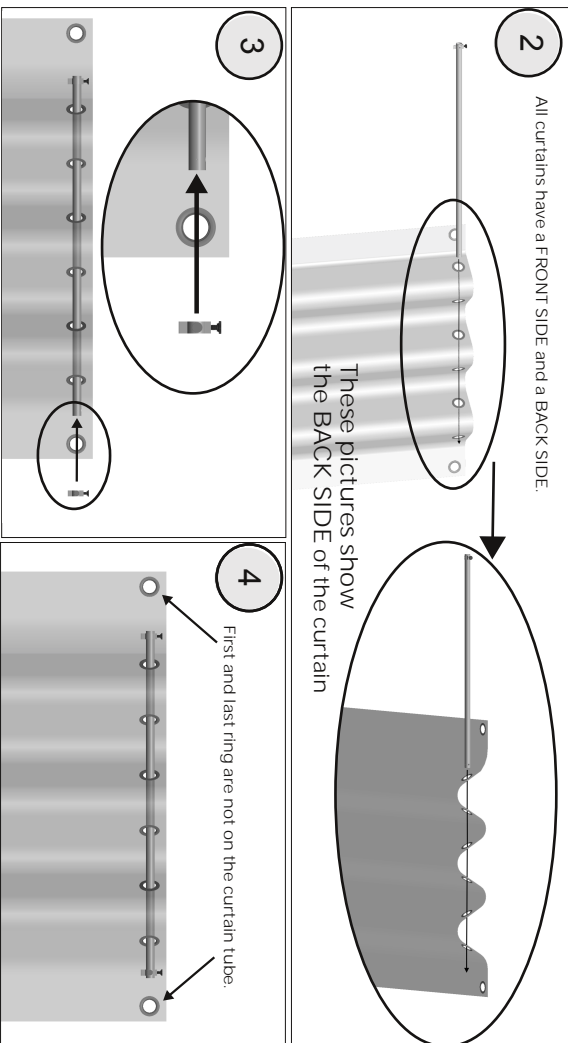

When all the curtains are correctly mounted on the curtain tube AND correctly mounted on the frame and you are standing IN FRONT of the screen:

- you see only the curtain tubes
- you don't see the frame
- you see the front side of the curtains



Curtains



If the Curtains are mounted correctly, you only see a flying curtain tube when you stand in front of the screen. The rest of the frame is behind the curtain. Follow the next instructions so you also have this.

Curtain must already be mounted on the curtain tube.

Mount the curtain tube to the frame.

Place the first and last ring on the spots A and B.

Curtain must already be mounted on the curtain tube.

First place a ring on spot A, against the previous curtain and mount the curtain tube to the frame.

Place the last ring on spot B.

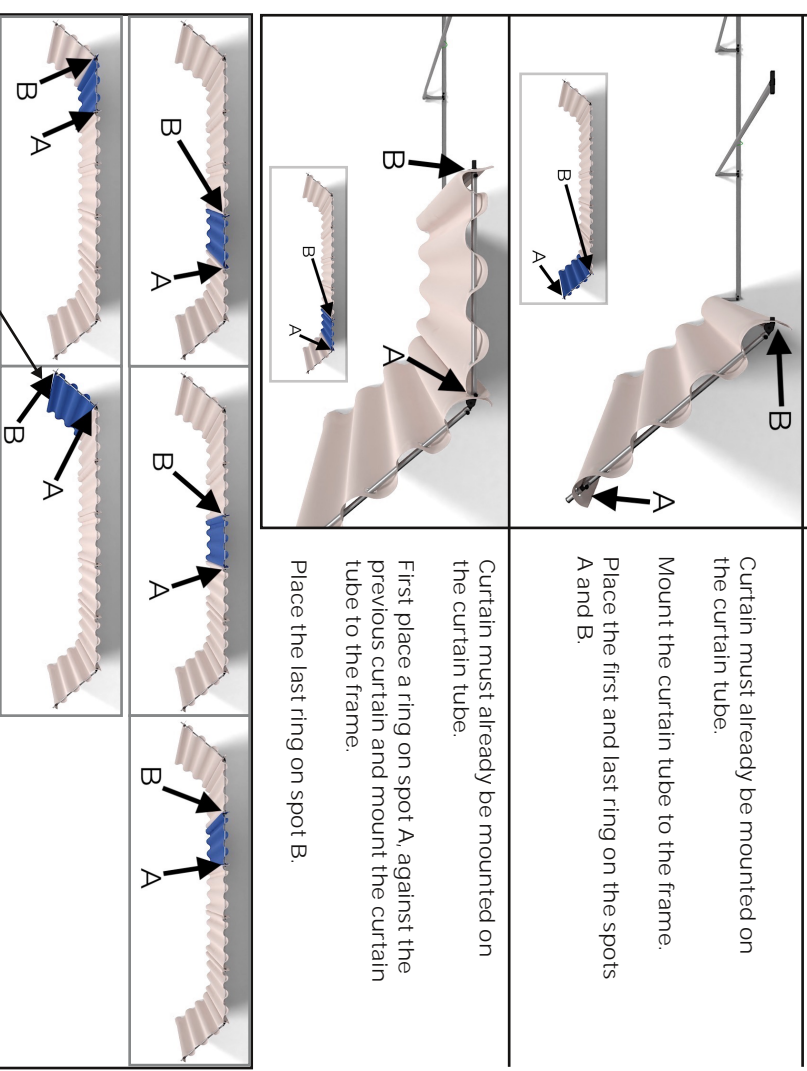

Repeat the previous instruction for these curtains.

Tip: Start with the curtain you last mounted when breaking down the room.

And end with the curtain you first mounted

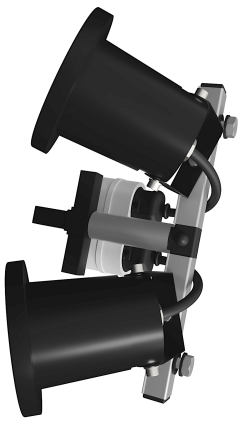

Light equipment for FrameBear

Pull the T part out of the tube.

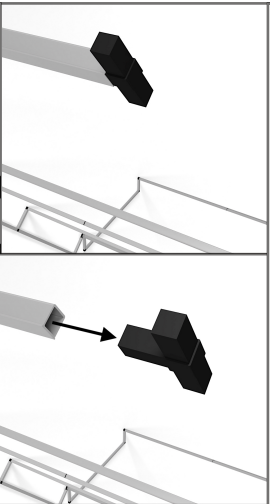

Push the light equipment.....



.....into the tube.

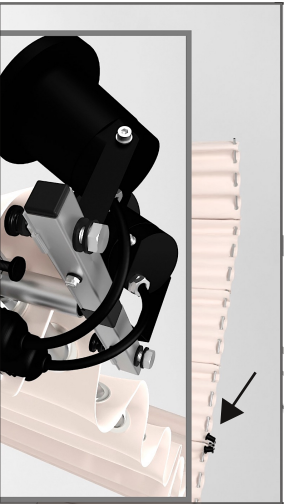

FrameBear

FB-Screen 7 meters

Check our instruction videos:

<https://thelightbear.com/support/support-fb-screen-7-meter/>

